

ONE11

PRELIMINARY PLAT
LOCATED IN THE NE & NW 1/4 OF SECTION 27, T2S, R2W,
SALT LAKE BASE & MERIDIAN
WEST JORDAN CITY, SALT LAKE COUNTY, UTAH

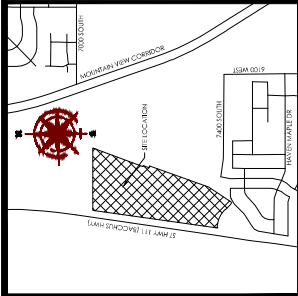

VICINITY MAP

LEGEND

- BOUNDARY
- SECTION LINE
- RIGHT-OF-WAY LINE
- EXISTING PROPERTY LINE
- SECTION MONUMENT (TO BE SET)
- STREET MONUMENT (TO BE SET)
- BOUNDARY MARKERS
- OPaque FENCE OR WALL
- DECORATIVE MASONRY WALL

NOTES:

- 1) 1/4 BEAR & CAP TO BE SET AT ALL BEAR LOT
- 2) BACK OF CURB AT THE EXTENSION OF THE SIDE LOT
- 3) ASSOCIATION AS COMMON AREA.

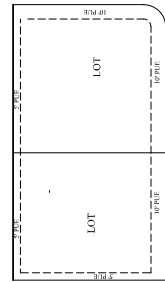

TYPICAL P.U.E.



ONE11

PRELIMINARY PLAT

LOCATED IN THE NE & NW 1/4 OF SECTION 27, T2S, R2W,
SALT LAKE BASE & MERIDIAN
WEST JORDAN CITY, SALT LAKE COUNTY, UTAH

CONTACT: RYAN CAMPBELL

6949 SOUTH HIGH TECH DRIVE SUITE 200
MIDVALE, UTAH 84047

www.focusus.com

ENGINEERING AND SURVEYING, LLC

2015-2016

2015-2016

