

811

Know what's below.
Call before you dig.

CALL BLUESTAKES
@ 811 AT LEAST 48 HOURS
PRIOR TO THE
COMMENCEMENT OF ANY
CONSTRUCTION.

BENCHMARK

NORTHWEST CORNER OF SECTION 35,
TOWNSHIP 2 SOUTH, RANGE 2 WEST
SALT LAKE BASE AND MERIDIAN

ELEV = 4943.07'

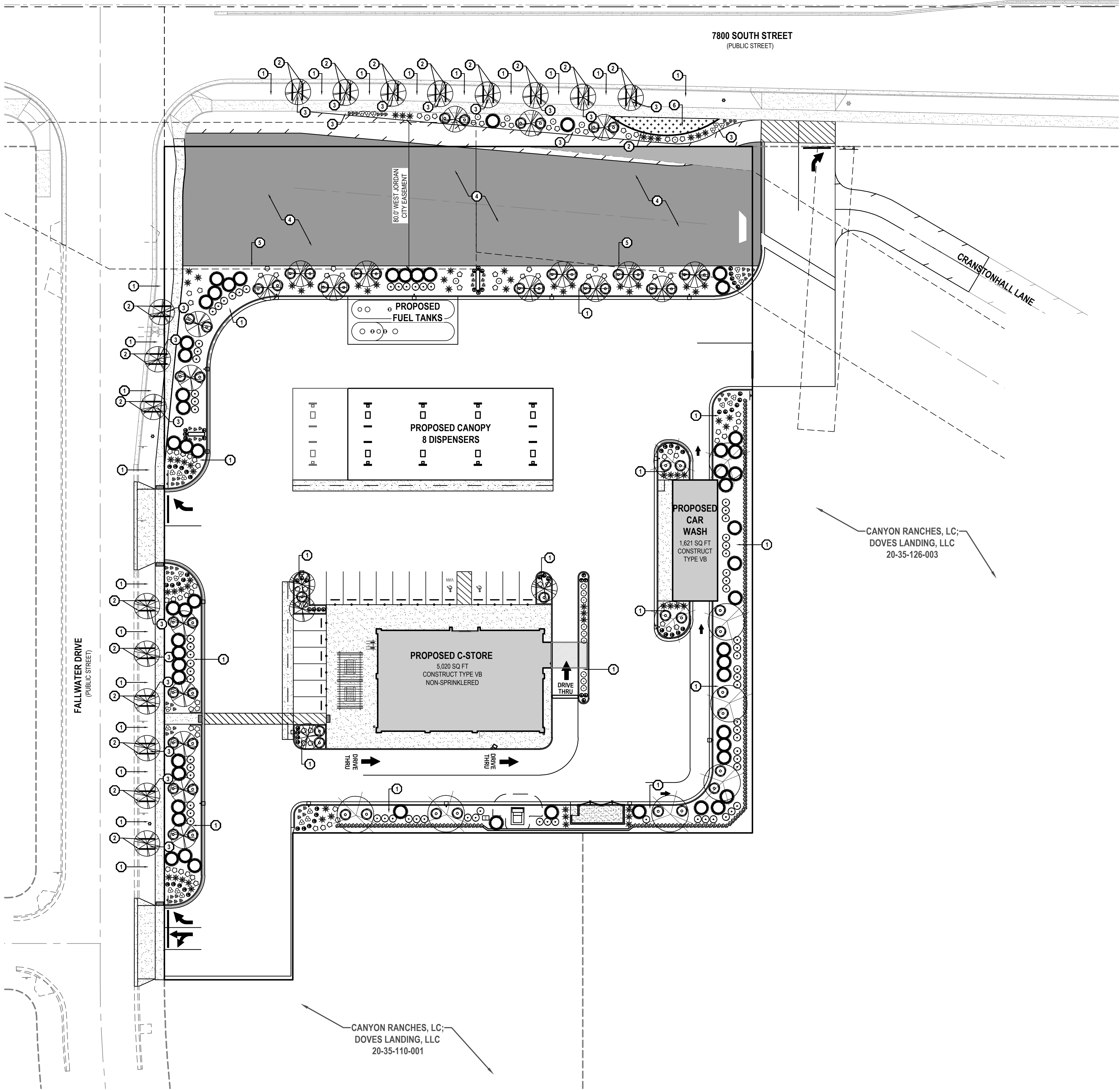

- GENERAL LANDSCAPE NOTES:**
- LANDSCAPE CONTRACTOR HAS THE OPTION TO SUBSTITUTE PLANT MATERIAL IF SPECIFIED GENUS, SPECIES, AND/OR VARIETIES ARE NOT LOCALLY OR REGIONALLY AVAILABLE. LANDSCAPE CONTRACTOR SHALL REPLACE SAID PLANTS WITH THOSE OF LIKE HARDINESS ZONE, SIZE, FORM, MOISTURE AND SOLAR REQUIREMENTS, AND MEET THE GENERAL INTENT OF THE ORIGINAL DESIGN. ANY REPLACEMENT PLANTINGS SHALL BE APPROVED BY ENSIGN ENGINEERING AND LAND SURVEYING INC. OR PROJECT REPRESENTATIVE PRIOR TO INSTALLATION. ALL REPLACEMENT PLANT MATERIALS SHALL CONFORM TO CITY APPROVED PLANTS. ALL PLANTING SUBSTITUTION WILL BE APPROVED BY CITY.
 - LOCATE ALL UTILITIES AND SITE LIGHTING CONDUITS BEFORE LANDSCAPE CONSTRUCTION BEGINS.
 - NOTIFY LANDSCAPE REPRESENTATIVE OF ANY LAYOUT DISCREPANCIES PRIOR TO ANY PLANTING.
 - FERTILIZE ALL PLANTS AT THE TIME OF PLANTING WITH TIME RELEASE FERTILIZER.
 - MULCH, PER PLAN, SHALL BE USED AS A FOUR INCH (4") TOP DRESSING IN ALL PLANT BEDS AND AROUND ALL TREES. SINGLE TREES OR SHRUBS SHALL BE MULCHED TO THE OUTSIDE EDGE OF THE SAUCER OR LANDSCAPE ISLAND.
 - LANDSCAPE CONTRACTOR SHALL INSTALL AN UNDERGROUND, POP-UP IRRIGATION SYSTEM WHICH PROVIDES COMPLETE COVERAGE OF THE SITE AND MEETS COUNTY/CITY REQUIREMENTS AT OR BEFORE THE INSTALLATION OF LANDSCAPE MATERIALS.
 - ALL LANDSCAPE MATERIALS SHALL BE IN COMPLIANCE WITH THE AMERICAN STANDARD FOR NURSERY STOCK (ANSI-Z60.1-1986)
 - CONTRACTOR SHALL USE AVAILABLE SUITABLE TOPSOIL THAT HAD BEEN STOCKPILED ONSITE. IF QUANTITIES ARE NOT SUFFICIENT TO MEET SITE MINIMUMS CONTRACTOR SHALL PROVIDE ADDITIONAL MATERIALS. ADDITIONAL MATERIAL SHALL BE SUPPLIED BY A COMMERCIAL TOPSOIL SUPPLIER
 - PROVIDE THE FOLLOWING TOP SOIL MINIMUMS:
A. 4" TOPSOIL IN ALL SOD AREAS
B. 6" TOP SOIL IN ALL PLANTER BEDS
 - WEED FABRIC SHALL BE A DEWITT SUNBELT WOVEN GROUND COVER INSTALLED W/ GROUND STAPLES ACCORDING TO MANUFACTURER RECOMMENDATIONS.

Trees					
Qty	Symbol	Common Name	Botanical Name	Plant Size	Water Zone
27		Bigtooth Maple	Acer grandidentatum	2" Cal.	1
8		Eastern Redbud	Cercis canadensis	2" Cal.	2

Shrubs					
Qty	Symbol	Common Name	Botanical Name	Plant Size	Water Zone
54		Creeping Juniper	Juniperus horizontalis	5 Gallon	1
54		Creeping Oregon Grape	Mahonia repens	5 Gallon	1
11		Barberry, 'Crimson Pygmy'	Berberis thunbergii atropurpurea nana	5 Gallon	2
73		Cinquefoil	Potentilla fruticosa 'Abbotswood'	5 Gallon	1
70		Winged Euonymus	Euonymus alatus 'Grove's Compactus'	5 Gallon	2
62		Pine, Mugo	Pinus mugo 'Compacta'	5 Gallon	1
73		Fountain Grass	Pennisetum setaceum	1 Gallon	2

Annuals-Perennials					
Qty	Symbol	Common Name	Botanical Name	Plant Size	Water Zone
47		Daylily	Hemerocallis	1 Gallon	2
20		Black-Eyed Susan	Rudbeckia hirta	1 Gallon	2

- Install 4" deep, 2"-3" dia. Nephi Rock and Gravel color 'Southtown' or equiv. decorative rock over weed barrier, typ.
- Install 4" concrete edging
- Install 4" deep bark mulch
- Install native seed mix by Granite Seed or Similar:
Hydro-Seed Seed Mix
Western wheatgrass (Pascopyrum smithii)
8.00
'Roadcrest' Crested Wheatgrass (Agropyron cristatum)
4.00
Streambank Wheatgrass (Elymus lanceolatus ssp. Psammophilus)
5.00
Mountain brome (Bromus marginatus)
8.00
Total 25 PLS lbs./acre
- Install 4" metal edging
- Install sod

Landscape Calculations:
Parking Lot Trees: 35 parking spaces / 7 = 5
Trees required = 5 trees
Trees provided = 5 trees

Fallwater Drive total frontage = 355 ft
Trees required = 355/25 = 14 trees
Trees provided = 14 trees

7800 South Street total frontage = 284 ft
Trees required = 284/25 = 11 trees
Trees provided = 11 trees

Interior Landscaping Trees: 39,422 / 2,000 = 20
Trees required = 20 trees
Trees provided = 20 trees

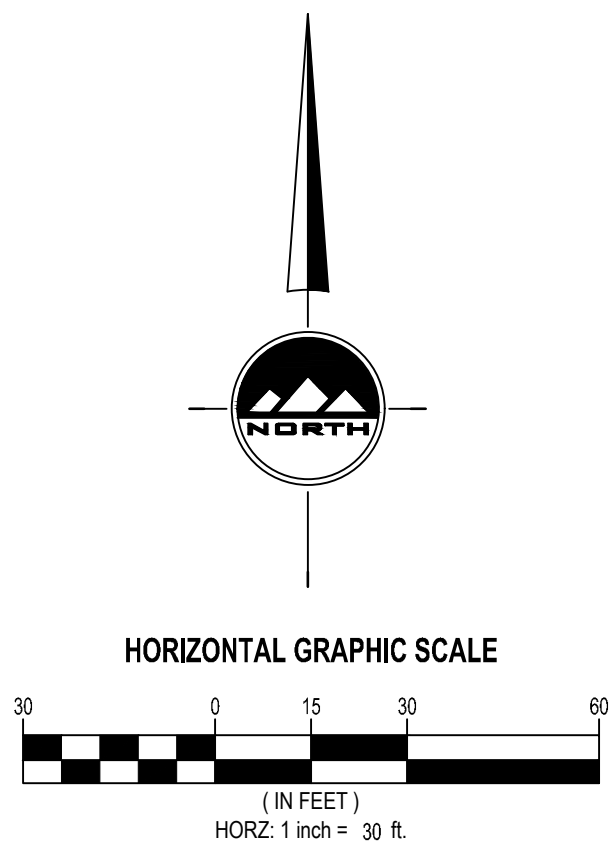

THE STANDARD IN ENGINEERING

SANDY
45 W 10000 S, Suite 500
Sandy, UT 84070
Phone: 801.255.0529

LAYTON
Phone: 801.547.1100

TOOELE
Phone: 435.843.3590

CEDAR CITY
Phone: 435.865.1453

RICHFIELD
Phone: 435.896.2983

WWW.ENSIGNENG.COM

FOR:
HOLIDAY OIL
3115 WEST 2100 SOUTH
WEST VALLEY CITY, UTAH

CONTACT:
SCOTT WAGSTAFF
PHONE: 801-973-7002

WEST JORDAN FALLWATER DR.

HOLIDAY OIL

6221 WEST 7800 SOUTH
WEST JORDAN, UTAH

LANDSCAPE PLAN

PROJECT NUMBER
11368

PRINT DATE
2024-02-22

PROJECT MANAGER
CD

DESIGNED BY
MB

L100